



ISLIP MIDDLE SCHOOL 2023-2024

Please visit IMS at:
www.islipufsd.org
sites.google.com/islipufsd.org/islipmiddleschool
Twitter: @IslipMS
Facebook.com/IsIipMS
Instagram: @islipms

Islip Middle School Mission Statement

Islip Middle School, in partnership with the community, will facilitate the academic, emotional, and social growth of our students, as they move to become well-rounded and lifelong learners. We shall create, through the unique elements of the middle school structure, an environment that will develop compassionate and creative problem-solvers, equipped to face the challenges of the 21st century.

I-BUC MORNING CHECK-IN



Did I eat breakfast?

Is my laptop fully charged?

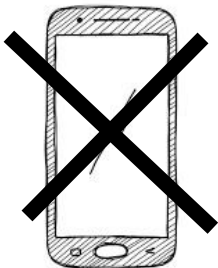
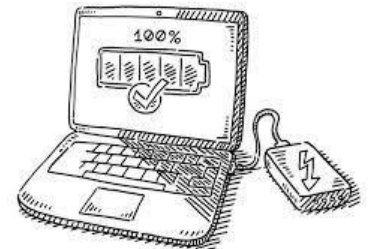

Is my CELL PHONE OFF
and Out OF 👁️ SIGHT?

TODAY WILL BE A GREAT DAY!

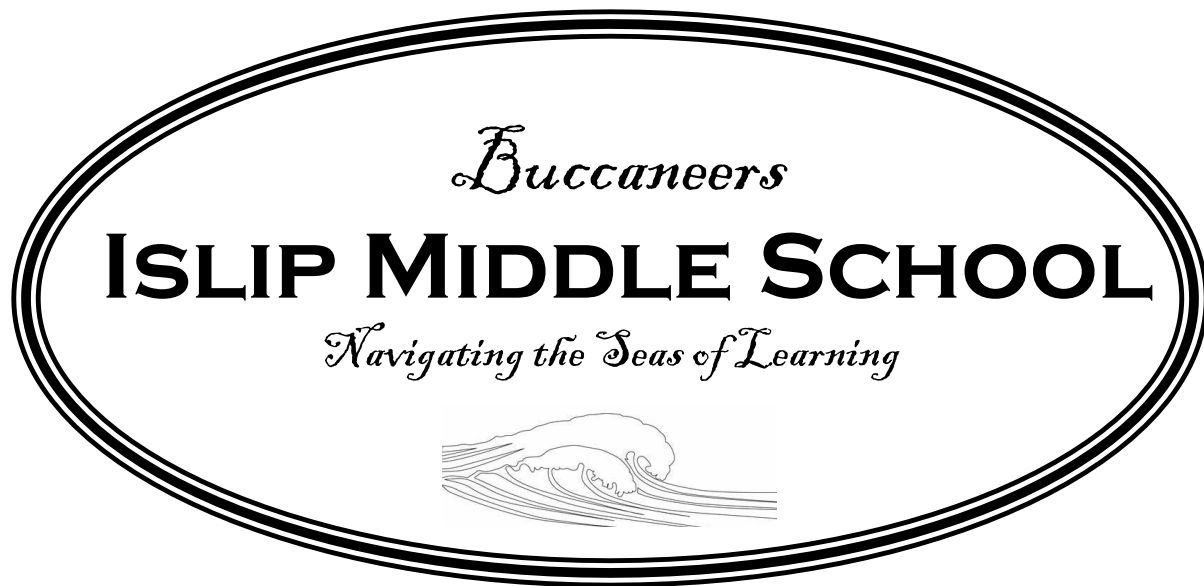

Name: _____

Team: _____ Advisor: _____

Locker Information:

To Open Your Locker You Must:

1. Turn the dial to the **RIGHT** two or more complete turns and stop at your **FIRST** combination number
2. Then, turn the dial **LEFT** one turn past the first number and stop at the **SECOND** combination number
3. Lastly, turn the dial **RIGHT** slowly to the **THIRD** combination number; lift the handle, and the door should open and close freely. To **RELOCK**, close the door and turn the dial one complete turn. **ALWAYS LOCK YOUR LOCKER!**

Combination Information:



Gym Locker Information:

Gym Locker Number: _____ Gym Locker Combination: _____

Decorating of Lockers:

Students are allowed to decorate lockers with the following understandings:

1. Students must have a signed pass from a teacher that is willing to supervise the students during decorating.
2. Students may only use magnets to place items on the locker. (No tape, sticky tack, adhesives, etc.)
3. All materials (pictures, graphics, etc.) must be school appropriate.

Expectations:

Positive attitudes and behaviors are encouraged by all. We ask all students to be kind, courteous, and cooperative with all their peers, teachers, and other staff members. We also ask that students respect their school. Students should keep their desks and surrounding areas clean; they should also dispose of all garbage in proper receptacles. Students should refrain from writing on desks, walls, or other school property in an effort to keep Islip Middle School a great place to learn.

No Problem! Just Call a “Study Buddy”

Students are urged to stay up to date with their assignments. Write the name of a person in each of your classes who will be reliable and whom you can call if you are absent from school. In cases of extended illnesses (3 or more days), contact the Guidance Office (631-650-8550) to arrange for your make-up work to be available for pick up. This should be done on the third day of absence. Homework will not be provided for a one-day absence. Any missed work will be given to students upon their return to the building; work should not be expected to be provided in advance of a planned absence.

Subject	Study Buddy	Contact Information

Student Planner Agreement

Date : _____

I, _____, have read the entire student planner and filled in the Study Buddy List. I am prepared to do everything I can to make this school year my best yet!

Student Signature : _____

Important Assessment Dates 2023-2024

6-8 NYS ELA Assessment	Apr 8 – May 17
6-8 NYS Math Assessment	Apr 8 – May 17
8th Grade NYS Science Performance Assessment	Apr 8 – May 17
8th Grade NYS Science Written Assessment	Apr 8 – May 17
8th Grade FLACS (World Language)	TBA
Algebra I Regents (Common Core)	June 4, 2024
Earth Science Regents	TBA

Please note all dates and times are subject to change by the NYS Dept. of Education.

IMS will have a Finals Week in June.
During Finals Week students will attend ½ days of school.

Directory of School Services		
Concern	Office to Contact	Telephone Number
Lockers	Assistant Principal's Office	631-650-8515
Behavioral Concerns		
Schedule Questions	Guidance Office	631-650-8550
Change of Address		
Extra Help Questions		
Emotional Concerns	Guidance/Social Worker	631-650-8550/631-650-8531
Absenteeism	Main Office	631-650-8510
Tardiness		
Early Dismissal		
Transportation	Administration	631-650-8275
Lost and Found	Main Office	631-650-8500
Illness	Health Office	631-650-8525
Important Phone Numbers		
Principal's Office		631-650-8505
Assistant Principal's Office		631-650-8515
Guidance Office		631-650-8550
School Psychologist		631-650-8532
Social Worker		631-650-8531
Student Enrollment		631-650-8405
Building Fax		631-650-8508

Contacting Teachers

Teachers may be contacted by phone or email. Call the Main Office and leave a message or go to the Middle School staff list on the school webpage and click on the teacher you would like to email.

Essential Partners

Consistent with the mission of the Islip School District, parents / guardians are considered essential partners in their child's education. Students have been asked to review this handbook with their caregiver. Parents are encouraged to keep in consistent contact with their child's teachers via the planner or other means of communication, as well as regularly checking the Infinite Campus portal. Together we can all make a difference in the lives of children and help them achieve successful outcomes.

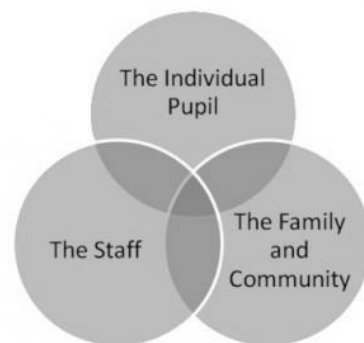

ISLIP MIDDLE SCHOOL 2023-2024 STUDENT CALENDAR

SEPTEMBER							OCTOBER							NOVEMBER							DECEMBER						
S	M	T	W	T	F	S	S	M	T	W	T	F	S	S	M	T	W	T	F	S	S	M	T	W	T	F	S
					1	2	1	2 ¹	3 ²	4 ³	5 ⁴	6 ¹	7				1 ²	2 ³	3 ⁴	4							
3	4	5	6	7	8	9	8	9	10 ²	11 ³	12 ⁴	13 ¹	14	5	6 ¹	7	8 ²	9 ³	10	11							
10	11 ³	12 ⁴	13 ¹	14 ²	15 ³	16	15	16 ²	17 ³	18 ⁴	19 ¹	20 ²	21	12	13 ⁴	14 ¹	15 ²	16 ³	17 ⁴	18							
17	18 ⁴	19 ¹	20 ²	21 ³	22 ⁴	23	22	23 ³	24 ⁴	25 ¹	26 ²	27 ³	28	19	20 ¹	21 ²	22	23	24	25							
24	25	26 ¹	27 ²	28 ³	29 ⁴	30	29	30 ⁴	31 ¹					26	27 ³	28 ⁴	29 ¹	30 ²			24	25	26	27	28	29	30
																					31						

JANUARY							FEBRUARY							MARCH						
S	M	T	W	T	F	S	S	M	T	W	T	F	S	S	M	T	W	T	F	S
7	8 ³	9 ⁴	10 ¹	11 ²	12 ³	13	4	5 ²	6 ³	7 ⁴	8 ¹	9 ²	10	3	4 ¹	5 ²	6 ³	7 ⁴	8 ¹	9
14	15	16 ⁴	17 ¹	18 ²	19 ³	20	11	12 ³	13 ⁴	14 ¹	15 ²	16 ³	17	10	11 ²	12 ³	13 ⁴	14	15 ¹	16
21	22 ⁴	23 ¹	24 ²	25 ³	26 ⁴	27	18	19	20	21	22	23	24	17	18 ²	19 ³	20 ⁴	21 ¹	22 ²	23
28	29 ¹	30 ²	31 ³				25	26 ⁴	27 ¹	28 ²	29 ³			24	25 ³	26 ⁴	27 ¹	28	29	30
														31						

KEY



School Closed



No School for students



Possible School Emergency Closing Days

- Sept. 4 Labor Day
- Sept. 5 & 6 Superintendent's Conf. Days
- Sept. 7 First Day of School for Students
- Sept. 25 School Closed, Yom Kippur
- Oct. 9 Columbus Day
- Nov. 7 Election Day / SCD
- Nov. 10 School Closed, Veteran's Day
- Nov. 22-24 Thanksgiving Recess
- Dec. 25-Jan. 1 Winter Recess
- Jan. 15 Martin Luther King Day
- Feb. 19-23 Mid-Winter Recess
- Mar. 14 Superintendent's Conf. Day
- Mar. 28 School Closed if No Snow Days Used
- Mar. 29-Apr. 1 Spring Recess I
- Apr. 22-Apr. 26 Spring Recess II
- May 24 & 28 School Closed if No Snow Days Used
- May 27 Memorial Day
- June 19 School Closed, Juneteenth
- June 25 Last Day of School for Students
- June 26 Islip High School Graduation

APRIL							MAY							JUNE						
S	M	T	W	T	F	S	S	M	T	W	T	F	S	S	M	T	W	T	F	S
7	8 ²	9 ³	10 ⁴	11 ¹	12 ²	13	5	6 ¹	7 ²	8 ³	9 ⁴	10 ¹	11	2	3 ²	4 ³	5 ⁴	6 ¹	7 ²	8
14	15 ³	16 ⁴	17 ¹	18 ²	19 ³	20	12	13 ²	14 ³	15 ⁴	16 ¹	17 ²	18	9	10 ³	11 ⁴	12 ¹	13 ²	14 ³	15
21	22	23	24	25	26	27	19	20 ³	21 ⁴	22 ¹	23 ²	24	25	16	17 ⁴	18	19 ¹	20 ²	21 ³	22
28	29 ⁴	30 ¹					26	27	28	29 ³	30 ⁴	31 ¹		23	24 ⁴	25	26	27	28	29
														30						

1 st Five Week Progress Period Ends	TBA
1 st Marking Period Ends	11/10/2023
2 nd Five Week Progress Period Ends	TBA
2 nd Marking Period Ends	1/26/2024
3 rd Five Week Progress Period Ends	TBA
3 rd Marking Period Ends	4/5/2024
4 th Five Week Progress Period Ends	TBA
4 th Marking Period Ends	6/21/2024

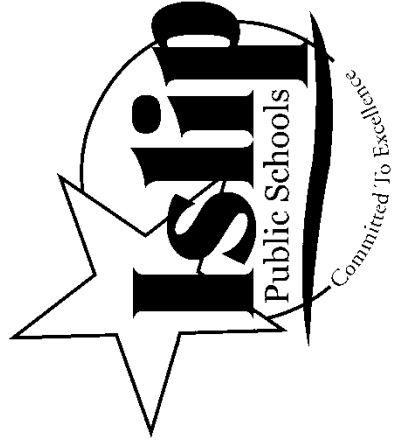

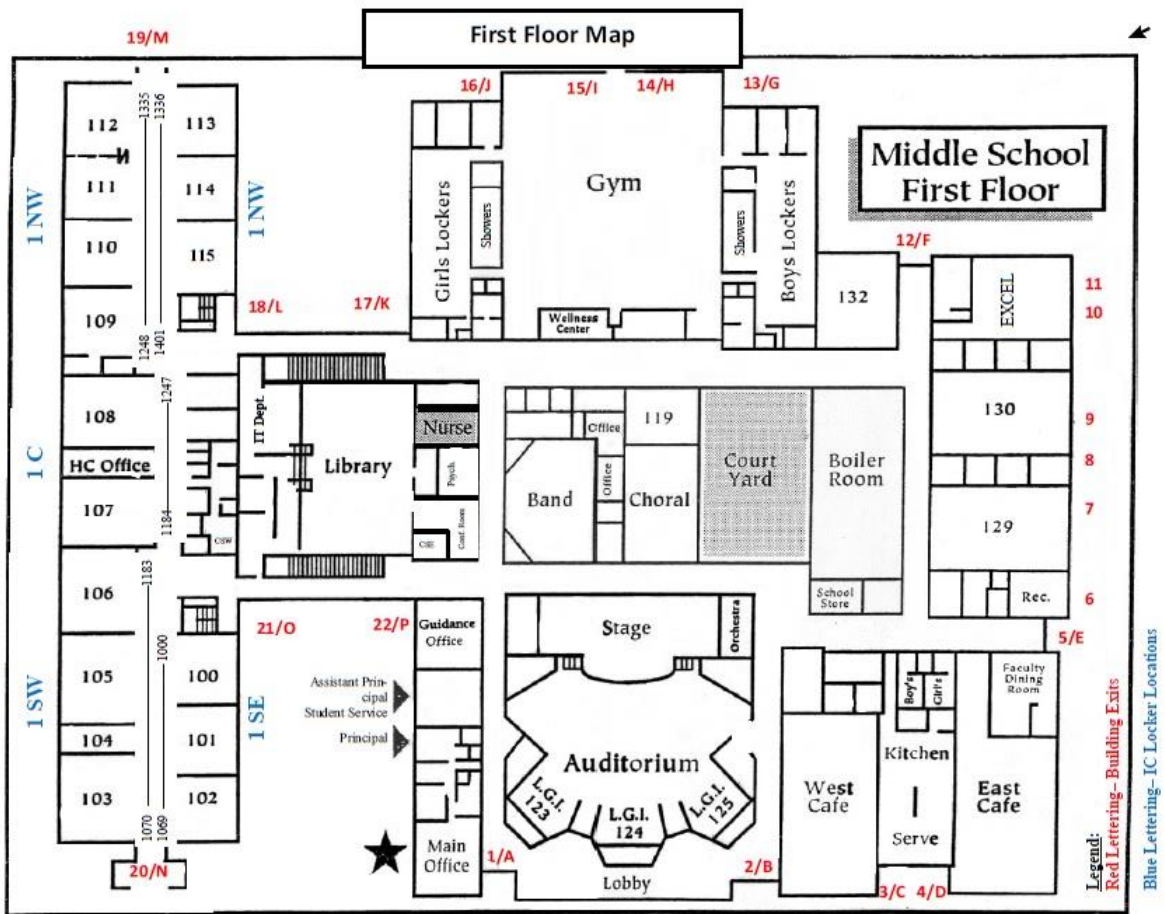

Second and Third Floor Map

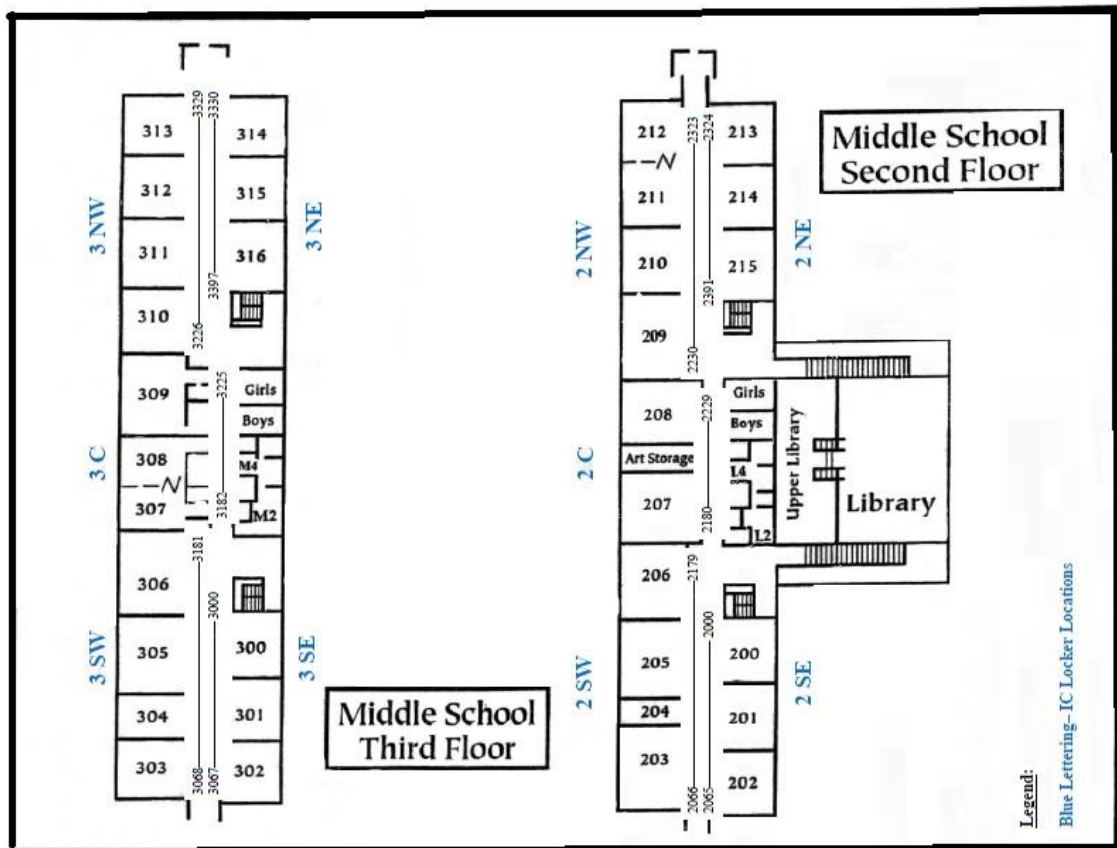

Intentionally Left Blank

Hall Pass

Passes

1. A pass from a staff member is necessary any time that you are in the halls during a class period.
2. Should you feel ill, a pass is necessary to go to the nurse. Students should check in with a teacher to get a pass.
3. If you need to call home, a pass is necessary to go to the Main Office or Assistant Principal's office to use the phone; students should refrain from using their cellphone for calls or text messages to contact home during the school day.
4. If you wish to go home on a different bus, you will need a bus pass from the Main Office. A letter from a parent is necessary to get the pass.
5. You will not be permitted to ride the late bus unless you have stayed after school for extra help, clubs, sports, detention, or another teacher supervised activity. Visiting a local merchant is not a valid reason to take a late bus.

Clubs
Art Club
Board Game Club
C.A.R.E. Club
Intramurals
IMS Show Choir
Italian Club
Jazz/Show Band
Kaleidoscope
KIC Club
Mathletes
Math Olympiad
Multi-Cultural Club
National Junior Honor Society
Science & Nature Club
Student Government
Theater Tech
Theater Drama
Video Journalism Club
Video Production Club
Yoga/Good Vibes
Clubs are reviewed annually and subject to change.

Lockers

It is your responsibility to keep your locker locked at all times. **Lockers should never be left open.** The school is not responsible for books or personal property placed in your hallway or gym locker. Items left out on benches during physical education or after-school sports are not considered secure and are the student's responsibility. Students should not share locker combinations with friends. Students are welcome to decorate friends' lockers if it is prearranged and supervised by a staff member (**see page 2 for details**). Students are welcome to decorate the outside of the locker provided all materials are appropriate and magnets are used to affix to the locker. (No tape, sticky tack, adhesives, etc.) We will hold periodic locker cleanouts that students are expected to participate in. **Please note: lockers are school district property and can be searched by school officials at any time.**

Early Dismissal

Unless you are sent home by the nurse due to illness, you must have a note from your parent or guardian stating the reason and time of dismissal if you must leave school early. The note must be given to the attendance office assistant, **that morning**, and you will be given a pass. When it is time to leave, show the pass to your teacher, and then report to the Main Office.

Please note: No student will be dismissed unless picked up by a parent or guardian.

Bicycles and Skateboards

1. If you ride a bicycle to school, you should follow all traffic regulations. According to New York State law, if you are under the age of 14, **you must wear a helmet**; this applies to bicyclists, skateboarders, and riders of scooters.
2. When on school property, students are not permitted to ride bicycles, skateboards, or scooters; these items must be walked or carried.
3. Bicycles must be locked in the racks located in front of the school building; they should not be locked to trees or light posts. The school district **is not** responsible for any bicycle that is damaged or stolen.



directions on the back of their elevator pass for fire drill procedures.

4. Stand with your class and teacher quietly so you can hear instructions for your safety.
5. NEVER pull a fire alarm if there is no emergency.
IT IS AGAINST THE LAW!

Textbooks/Calculators

You are responsible for your textbooks and calculators. Cover your textbooks to protect them. If a textbook or calculator is damaged or lost, a replacement cost is to be paid for the item.

Dining Room and Recess

1. All food and drink remain in the dining room.
2. Students have a choice of games **OR** outside recess after they clean their areas.
3. If students wish to participate in outside recess, it is their responsibility to dress appropriately; once outside, students are not permitted back inside until the end of the period.
4. Parents are asked not to bring fast food to school during their child's lunch period.
5. Birthday parties or other celebrations are not appropriate to have in the dining room; these **must** be pre-arranged and supervised by a staff member in a classroom.
6. Students should not bring trays of food or oversized beverages into school as it causes a disruption to the dining room.
7. Students should not be taken out of school during their lunch period if it can be helped.
8. Beverages (Red Bull, Monster, coffee, hot drinks etc.) and glass bottles are not permitted in school.
9. If you have a known food allergy, the nurse should be notified **immediately!**

Fire Drill Conduct

1. When the alarm sounds, listen for instructions from your teacher and exit from your assigned location. If you are not with a class when the alarm sounds, exit from the nearest door.
2. Walk **quickly** and **silently** in an orderly fashion, moving away from the building.
3. Students who use the elevator should follow the



Medication

If it is necessary for you to take **ANY FORM** of medication in school, a parent must bring the medication and a doctor's note to the Health Office. The nurse will keep and will dispense all medication.

Bus Rules and Regulations

1. Behavior that is not acceptable in school is not acceptable on the bus.
2. Always carry your bus pass that is issued in September. Students should always get off at the stop designated on their pass.
3. Respect the driver by cooperating, being reasonably quiet, and following all of the driver's directions.
4. Respect bus property and the property of others on the bus.
5. Practice safety rules by keeping your entire body inside the bus and remain seated while the bus is moving. Always cross the street at least six feet in front of the bus in full view of the driver. Never cross behind the bus. Always use crosswalk in front of building.
6. If you wish to take a friend's bus, you **MUST** have a note from your parent or guardian. Bring the written note to the Main Office during advisory or during your lunch period where you will be given a pass. No verbal permission will be granted.
7. Students cannot switch their bus without the approval of a parent **AND** an administrator.
8. Once arriving on school grounds in the morning, students may not leave the property **FOR ANY REASON**.
9. Students who do not have a valid reason for staying after school (club, sport, extra-help) **WILL NOT** be permitted to ride the late bus home from school. **Visiting a local merchant or staying after hours unsupervised on school property is not a valid reason to take a late bus.** Students should remember that riding the bus is a privilege, and if they do not follow the rules, this privilege will be taken away.



Student Recognition

Students can receive recognition in one of the following areas throughout the year:

1. **Principal's Honor Roll** - overall average of 90% or higher and no grade below 85%.
2. **Honor Roll** - overall average of 85% and no grade below 80%.
3. **Merit Roll** - overall average of 80% and no grade below 75%.
4. **On a Roll** - overall average must increase by 5 points from the previous quarter whether or not that grade is below passing. To stay "on a roll" students should maintain the previous passing average **OR** the average should increase by another 5 points from the previous quarter, whether or not that grade is below passing.



No student can receive a "U" or "F" for any of the above recognitions.

5. **Students in Good Standing:** To be considered, a student will maintain the necessary academic grades, behavior/discipline record, as well as appropriate attendance record. A student in good standing has met the necessary requirement to participate in extracurricular activities (field trips, athletics, clubs, etc.).
6. **Islip Marches Ahead** - each teacher may select one student per quarter based on academic growth and effort put forth in their class.
7. **C.A.R.E. Program** – Any staff member may select one student per quarter that exemplifies what it is to be a good citizen. **C**ompassion, **A**ttitude, **R**esponsibility, and **E**mpathy are the traits we instill in all of our students for positive behavior.

Renaissance Rewards Program

Academic				
Gold	Purple	Red	Blue	Aqua
- Average of 90 or above - No grade below 85	- Average of 85 or above - No grade below 80	- Average of 80 or above - No grade below 75	- 5 point increase of GPA - No incompletes	- Recipients of C.A.R.E. Awards or recognition for Islip Marches Ahead
<p>Students have three weeks after the end of the marking period to make any necessary changes to their report cards. Grade changes made after three weeks will not affect Renaissance Card status.</p>				
Attendance				
Gold	Purple	Red	Blue	Aqua
- No more than two unexcused absences per quarter - No more than two tardies to school per quarter	- No more than two unexcused absences per quarter - No more than two tardies to school per quarter	- No more than two unexcused absences per quarter - No more than two tardies to school per quarter	- No more than two unexcused absences per quarter - No more than two tardies to school per quarter	- Recipients of C.A.R.E. Awards or recognition for Islip Marches Ahead
<p>Students are required to bring absentee and late notes to their advisor by the end of each marking period. Family vacations ARE considered illegal absences.</p>				
Behavior				
Gold	Purple	Red	Blue	Aqua
- NO behavior referrals (school, bus, or dining room)	- NO behavior referrals (school, bus, or dining room)	- NO behavior referrals (school, bus, or dining room)	- NO behavior referrals (school, bus, or dining room)	- NO behavior referrals (school, bus, or dining room)
Rewards				
<ul style="list-style-type: none"> Rewards may include but are not limited to: Discount with local merchants; raffle tickets per quarter; Lunch period party; Prize or Snack Voucher; End of year ice cream party. All Renaissance Reward recipients will be treated to quarterly rewards. ALL cardholders will receive various additional rewards at card validation events. Any card lost will be subject to a replacement fee. 				

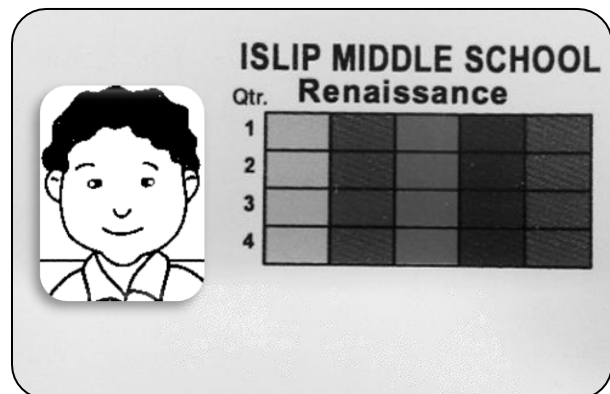

National Junior Honor Society

When you are in 7th or 8th grade, you can become a member of the National Junior Honor Society if you maintain an overall average of 94% or higher for the first three marking periods in all subjects. In addition, you must exhibit good character, good citizenship, leadership, and service. Students will be expected to participate in community service activities as per the club charter.



Student Evaluation

At the end of each ten-week marking period, a report card representing student scholastic achievement and effort to date will be available on the Infinite Campus Parent Portal. In addition, progress reports will be available on the Parent Portal around the fifth week of each marking period. Students' quarterly grades and final exam grades will comprise final averages; each quarter and the final exam will count for 20% of the final average. Please contact the Main Office at 631-650-8500 for information on accessing the Parent Portal.

Promotion Policy

In order to be promoted, a student must obtain an overall average of 65% and have passed at least three major subjects if enrolled in world language. If you do not take a world language, you must pass two major subjects and have an overall average of 65%.

Extra Help

Homework support meets Monday-Thursday. Students should check the guidance office for time and location. Students should be punctual and prepared to work. Students can also seek extra help from their teachers. It is the students' responsibility to make arrangements.

Band, Orchestra & Chorus

Students taking band, orchestra, or chorus may attend AM extra-help **three** times per quarter with permission from the ensemble conductor, parent, **and** the teacher providing the extra help. Students cannot attend AM extra-help the **last four** rehearsals before a concert.

Guests

On occasions, school sponsored events will provide an opportunity for families to observe their children's accomplishments. These events will be preceded with the proper permission slips. At no other time are students permitted to have a guest attend school.

Fundraising

The Islip Middle School supports many community service activities. However, any fundraising must be sponsored by a school club and supervised by a staff member. Individual students are not permitted to solicit money for fundraising or sell items without the permission of administration and a staff supervisor.

IMS Attendance Policy

Attendance policies are based on the principle that regular school attendance maximizes the student's interaction with his or her teachers and peers and is a major component of academic success.

Consistent school attendance increases student achievement. We believe that frequent pupil absence from regular classroom learning experiences disrupts the continuity of the instructional process. Furthermore, the New York State Board of Regents has required school districts to revise their attendance policies to comply with their regulations. Attendance will be taken each period of the school day. Islip's Comprehensive

Student Attendance Policy addresses absences, tardiness, and early departures. This page outlines the Islip Middle School attendance procedures.

Attendance Procedures

Absences

A parent or guardian must contact the attendance secretary at 631-650-8510 between 8 a.m. and 9 a.m. the morning of the absence; if this is not done, an automated call will be made home. Students should bring an absentee note in the next morning and give the note to their advisor.

Students are responsible for all work missed. The parent/guardian must contact the child's guidance counselor to arrange for work to be sent home prior to 9 a.m. **on the third consecutive day of excused absence.** Students should use their study buddy for absences of one or two days.

Attendance verification will be conducted every quarter. The Guidance Office will review attendance, and a letter will be sent home with a list of questionable/excessive/illegal/unexcused absences.

Students absent five or more consecutive days must get readmitted to school via the Health Office and must have a note from a physician.

Lateness to School

Students must sign in at the Main Office with a note explaining lateness.

Parents or guardians will be notified when their child is late three or more times without a note.

Excessive or consistent lateness may result in consequences. Consequences will be based on the rubric on page 16.

Lateness to Class

A student's classroom teacher will address lateness to class. Three or more lateness's to class may result in teacher or administrative consequences. Administrative assistance will be provided upon request of the teacher.

Cutting School/Class

After it is determined that a student has cut a class, the parent/guardian will be notified, and a student will be assigned a consequence.

If subsequent cutting of classes or school occurs, the consequences will increase in severity. In addition, the student's guidance counselor and/or school social worker will provide educational awareness regarding the importance of attending classes. If school intervention is not successful, a charge of educational neglect may be filed.

Glossary

Excused Absences/Lateness/Early Departures

Any absence, lateness, or early departure due to personal illness; illness or death in the family; impassable roads; inclement weather; religious observance; quarantine; legal circumstances; attendance to health care provider; approved college visits; approved cooperative work programs; military obligations; or other appropriate reasons may apply.

Unexcused Absences

Any absence that does not meet the above-mentioned criteria or definition as per the Commissioner's Regulations.

*****Please review the Islip Public Schools' attendance policy and procedure at the district website: www.islipufsd.org***

Islip Middle School Code of Conduct

In Compliance with:

Safe Schools Against Violence in Education; New York State Law, July 2001, Rev. August 2011

The Dignity for All Students Act; New York State Law, July 2012, Rev. July 2013

Overview

Islip Middle School expects all students to conduct themselves in an appropriate and civil manner, with proper regard for the rights and welfare of other students, district personnel, other members of the school community, and for the care of the school, facilities, and equipment. The best discipline is self-imposed, and students must learn to assume and accept responsibility for their own behavior, as well as the consequences for their misbehavior.

The development of empathy is an important piece of the emotional growth of an adolescent. The ability to place oneself in another's shoes is a life skill that we strive to teach students.

District personnel who interact with students are expected to use disciplinary action only when necessary and to place emphasis on the student's ability to grow in self-discipline.

Islip Middle School recognizes the need to make its expectations for student conduct on school property or at a school function specific and clear; the rules of conduct listed here are intended to do that by focusing on learning, safety, and respect for the rights of others. Students who will not accept responsibility for their own behavior, and who violate school rules, will be required to accept the penalties for their conduct. Students may be subject to disciplinary action up to and including suspension from school.

Student Harassment and Bullying

Islip Middle School is committed to providing an educational environment that promotes respect, dignity, and equality. Islip Middle School recognizes that discrimination, such as harassment, hazing, and bullying are detrimental to student learning and achievement. Islip Middle School tries to instill Compassion, Attitude, Responsibility, and Empathy in all students.



The Islip Middle School condemns and strictly prohibits all forms of discrimination, such as harassment, hazing, and bullying on school grounds, school buses, and all school sponsored activities, programs, and events. Any of the above-mentioned behaviors that take place off of school grounds, including but not limited to cyber bullying, and that may interfere with a child's learning experience may be subject to disciplinary action.

Discrimination	The act of denying rights, benefits, justice, equitable treatment, or access to facilities available to others, to an individual, or group of people because of the group, class, or category to which that person belongs.
Harassment	The creation of a hostile environment by conduct or by verbal threats, intimidation, or abuse that has or would have the effect of unreasonably or substantially interfering with a student's educational performance, opportunities, benefits, or mental, emotional, or physical well-being; or conduct, verbal threats, intimidation or abuse that reasonably causes, or would reasonably be expected to cause a student to fear for his/her physical safety.
Hazing	An induction, initiation, or membership process involving harassment which produces public humiliation, physical or emotional discomfort, bodily injury, or public ridicule, or creates a situation where public humiliation, physical or emotional discomfort, bodily injury, or public ridicule is likely to occur.
Bullying	A hostile activity which harms or induces fear through the threat of further aggression and/or creates terror.

Any of the above behaviors made on the basis of any characteristic including but not limited to a person's race, color, weight, national origin, ethnic group, religion, religious practice, disability, sex, sexual orientation, or gender are strictly prohibited.

The school's setting provides an opportunity to teach children, and emphasizes among staff, that cooperation and the respect for others is a key school value. The school cannot effectively address behaviors if they are not reported.

Students who have been bullied, parents whose children have been bullied, or other students or staff that observe bullying behavior are encouraged and expected to make a verbal and/or written report to school personnel. While the focus of this policy is on prevention, please know that the above-mentioned behaviors may still occur. In these cases, the offending students will be given a clear message that their actions are wrong, and their behavior must improve. The consequences for a student who commits any of the above-mentioned behaviors shall be unique to the individual incident and will vary in method and severity according to the nature of the behavior, and the student's history of problem behaviors, and must be consistent with the District's Code of Conduct.

Cell Phones

All students are expected to adhere to the IMS cell phone protocol, which is no cell phone use during the school day. Students who do not have their cell phone powered off and out of sight will have their device confiscated with a potential disciplinary action to follow. Students using electronic communication, entertainment, and music devices, including but not limited to cellular phones, texting devices, pagers, and/or smartphones/watches, without prior consent from the principal or their designee will have the device confiscated with a potential disciplinary action to follow.

Dress Code

All students are expected to give proper attention to personal cleanliness and to dress appropriately for school and school functions. Students and their parents/guardians have the primary responsibility for acceptable student dress and appearance. Teachers and other district personnel should exemplify and reinforce acceptable student dress and help develop an understanding of appropriate appearance. Students not meeting the criteria below will be expected to change their clothing (if available), and contact home (if necessary); if appropriate attire is unavailable, a child risks being removed from classes and disciplined if deemed repeat offenders to this procedure.

A student's dress, grooming, and appearance, including hairstyle/color, jewelry, make-up, and nails shall:



1. Be safe, appropriate, and not disrupt or interfere with the educational process.
2. Recognize that extremely brief, tight, and/or see-through garments are **NEVER** appropriate. This includes, but not limited to plunging necklines (front and/or back), bare midriffs, bare backs, muscle shirts, pajamas, short shorts, and short skirts; none of these garments are appropriate in a school setting.
(Length of shorts should be \geq fingertip length when arms are fully extended.)
3. Coats must be kept in lockers at all times.
4. Ensure that undergarments are completely covered with outer clothing.
5. Include footwear at all times. Footwear that is a safety hazard is not allowed. Students should not wear plastic/rubber/cork beach sandals, slippers, flip-flops, slides or any other such footwear.
6. Not include the wearing of headgear anywhere on their person during the school day to include, but not limited to hats, bandanas, sweatbands, and kerchiefs in the classroom except for medical or religious purposes.
7. Not include items that are vulgar, obscene, libelous, or denigrate others on account of race, color, weight, national origin, ethnic group, religion, religious practice, disability, sex, sexual orientation, or gender; nor promote the use of alcohol, tobacco, or illegal drugs, and/or encourage any other illegal, violent, or offensive messages and/or activities.
8. Make sure that any clothing and/or accessory that is deemed disruptive to the educational process is not worn.

Student Health and Welfare

We ask that students not use items in school that can be distracting or harmful to others. Guidelines are as follows:

1. Cellphones, iPods, or other electronic devices should not be visible and should remain in lockers if brought to school.
Texting, making calls, or other use of a cellphone and Smart Watch technology, listening to music, playing electronic games, taking photos or video are strictly prohibited during the school day. Furthermore, cellphones are not permitted in locker rooms or restrooms. If an electronic device is taken by IMS staff, it will be brought to the AP office, and the student may be subject to consequences. Online activity, which may include but is not limited to texting, sexting, sextortion, etc., can result in student discipline.
2. Tablets and/or eReaders (Kindles, Nooks, etc.) may only be used during advisory relax and read, in the library, or in class as appropriate (such as reading a class novel) if given permission from a staff member. Other uses of these devices (texting, surfing the web, gaming, listening to music, taking photo or video) are strictly prohibited.
3. Water guns, air-soft guns, laser pointers, pocket knives, and other weapons or handheld devices are not permitted on school property or at school-related events.

4. Aerosol sprays or colognes/perfumes of any kind should not be brought to school.
5. Chewing gum **anywhere** is prohibited.
6. Students must respect personal space. Holding hands, hugging, and kissing are not appropriate on school grounds.
7. Once a student is on school grounds, they may not leave until dismissal. Furthermore, once a student leaves the building at dismissal, they are not permitted back in.
8. Keep in mind, if you are wondering or have to ask if an item is inappropriate, the answer is most likely **YES!**
9. The school is not responsible for any prohibited electronic devices that are lost, misplaced, damaged, or stolen.

Islip Middle School believes that if students are respectful, responsible, and have positive relationships, positive results emerge.				
	Respect: Be considerate of people and property. Students show respect by:	Responsibility: Take ownership of all your actions, decisions, and thoughts, right or wrong. Students show responsibility by:	Relationships: <u>Conduct positive interactions with all people at all times.</u> Students show positive relationships by:	Results: Personal, academic, and social success. Positive results include:
<p style="text-align: center;">The IMS Learning Environment</p> 	<ul style="list-style-type: none"> • Moving safely around the school • Using appropriate voice level, <u>language</u> and topics • Speaking to school staff, <u>students</u> and visitors respectfully • Using school technology appropriately • Being respectful of other people's personal space • Entering classes on time, calmly, and quietly • Always walking and keeping hands and feet to themselves • Waiting their turn patiently • Waiting quietly until dismissed by teacher 	<ul style="list-style-type: none"> • Following the Code of Conduct • Being prepared and on time • Completing assigned tasks • Using material and equipment appropriately • Leaving the area cleaner than they found it • Being responsible for school property • Being prepared, on time, and ready to learn • Being productive • Using the planner everyday • Turning in completed work on <u>time</u> • Cleaning up after themselves 	<ul style="list-style-type: none"> • Treating others as they would like to be <u>treated</u> • Being honest, being helpful, being positive • Respectfully listening to others • Working cooperatively • Interacting positively with all people, and • Inviting others into your peer group 	<ul style="list-style-type: none"> • A school that is safe, successful, and respectful for students, staff, and visitors • School pride • A successful learning environment
<p style="text-align: center;">Dining Room/ Recess</p> 	<ul style="list-style-type: none"> • <u>Showing good manners at all times</u> • Keeping the lunch area clean • Remaining seated unless it is their turn to get on <u>line</u> • Responding respectfully when addressed by an <u>adult</u> • Using appropriate voice level, language, and topics • Waiting for their turn in line • Following adult directions • Being respectful of other students • Using recess equipment with care • Playing games in the space provided • Entering and exiting the building promptly and safely 	<ul style="list-style-type: none"> • Leaving dining room only with staff permission • Cleaning up the area and spills • Putting their trays and trash in wastebaskets • Always walking and moving calmly and quietly • Keeping hands, feet, and food to themselves • Sitting safely at assigned <u>tables</u> • Leaving recess only with staff permission • Playing games by the rules and not playing contact sports • Getting help resolving a disagreement when needed • Returning the equipment at the end of recess 	<ul style="list-style-type: none"> • Speaking positively and politely to all • Respecting the personal space of others • Making room for others as needed • Listening quietly when directions are being <u>given</u> • Keeping hands and feet to yourself • Using good sportsmanship • Respecting others' games that are in progress • Including others and sharing equipment • Inviting others into your peer group 	<ul style="list-style-type: none"> • Lunch is enjoyable for <u>all</u> • Floors are safe and <u>clean</u> • The spread of illness is <u>prevented</u> • Recess is safe and <u>enjoyable</u> • Equipment will last <u>longer</u> • Games are <u>enjoyable</u>
<p style="text-align: center;">Buses</p> 	<ul style="list-style-type: none"> • Moving safely • Waiting patiently • Speaking appropriately to students, staff, and bus drivers • Getting to the bus on time • Getting on the correct bus and getting on and off at the assigned bus stop • Entering bus calmly and quietly • Using appropriate voice level, language, and topics • Respecting people's personal space 	<ul style="list-style-type: none"> • Understanding that all school expectations apply to all bus <u>stops</u> • Going directly to your destination • Get a bus pass during advisory or lunch if you need to ride another bus in the <u>afternoon</u> • Following bus rules and directions of bus drivers • Cleaning up • Using technology responsibly • Obeying all health and safety regulations • Going directly to their buses upon dismissal 	<ul style="list-style-type: none"> • Being polite to adults and peers • Respecting others' space • Treating others as they would like to be <u>treated</u> • Interacting positively with bus driver and other students • Respecting the instructions of all school personnel assisting with buses • Inviting others into your peer group 	<ul style="list-style-type: none"> • There will be a safe and pleasant start and end to each <u>day</u> • Buses arrive and leave on <u>time</u> • Bus ride is safe and enjoyable for <u>all</u> • Positive social time with peers • Maintaining the privilege of riding the bus

ISLIP MIDDLE SCHOOL GUIDELINES FOR DISCIPLINE POLICY

Potential Behavioral Infractions				
LEVEL 1	LEVEL 2	LEVEL 3	LEVEL 4	LEVEL 5
<p><u>INCLUDING BUT NOT LIMITED TO</u></p> <ul style="list-style-type: none"> - Littering - Loitering - Lateness to class or school - Running in the hallways - Misuse of hall passes - Violations of dress code 	<p><u>INCLUDING BUT NOT LIMITED TO</u></p> <ul style="list-style-type: none"> - Repeated level 1 infractions - Use or view of electronic devices (i.e., cellphone, iPod, etc.) during school hours - Cutting assigned detentions - Disruptive behavior in class - Disruptive behavior on school property (to include before & after school, buses, sporting events, socials, etc.) - Name calling - Expression of drugs, alcohol use, violence, sex, bias remarks either in writing, via electronic media, or on clothing, hats, etc. - Continuous disregard and violation of the dress code procedure - Forgery 	<p><u>INCLUDING BUT NOT LIMITED TO</u></p> <ul style="list-style-type: none"> - Repeated level 1-2 infractions - Academic integrity; plagiarism - Acts of graffiti or vandalism - Cutting classes or school; truancy - Inappropriate computer use on the school network - Intimidation, bullying of others to include cyber bullying and inappropriate texting (including nexus events) - Insubordination towards <i>any</i> staff member - Threats of physical harm - Use of vulgar or abusive language; cursing or swearing - Verbal Harassment - Push / Shove; physical altercation (aggressor) - Push / Shove; physical altercation (defender) 	<p><u>INCLUDING BUT NOT LIMITED TO</u></p> <ul style="list-style-type: none"> - Repeated Level 1-3 infractions - Gross insubordination towards any staff member - Engaging in lewd and inappropriate behavior - Selling, using, transmitting, or possession of obscene materials - Buying or selling items not approved by administration - Defamation of character towards staff or students - Physical harassment - Threats of serious physical violence - Failure to follow direction during an emergency - Use of photo / video capable electronic devices (cameras, phones, Smart Watches, etc.) during the school day - Posting / publishing photos or videos related to school personnel or student body in an online environment 	<p><u>INCLUDING BUT NOT LIMITED TO</u></p> <ul style="list-style-type: none"> - Repeated Level 1-4 infractions - Sexual harassment/sexting - Transmission of threats - Participating in a fight - Assault and/or threats - Damaging of property - Using or possession of drugs (to include OTC), alcohol, or tobacco products, inappropriate liquids or related paraphernalia - Theft - Possession of weapons - Extortion/Sextortion - Endangering the health of others - Gambling - Initiation or involvement in false alarms, calling 911, discharging of fire extinguisher, tampering with fire alarm, or AED - Use of fireworks or any other incendiary/explosive devices including stink bombs and snaps - Acts of bias/discrimination - Hazing - Trespassing - Possession and/or use of a vape pen or e-cigarette
Potential Consequences				
LEVEL 1*	LEVEL 2*	LEVEL 3*	LEVEL 4*	LEVEL 5*
<ul style="list-style-type: none"> - Warning - Counseling - Lunch detention (short term) - Administrative time out 	<ul style="list-style-type: none"> - Warning - Counseling - Lunch detention (short term) - Administrative time out - After-school detention (short term) - Bus warning (as applicable) - Possible seating assignment change (classroom or dining room) - Cell phone will be confiscated by a staff member 	<ul style="list-style-type: none"> - Counseling - Lunch detention (long term) - After-school detention (long term) - Bus suspension; all buses (short term) - Full day detention(s) - Removal from all extra-curricular activities; including trips (short term) - Possible schedule change - Parent retrieves phone 	<ul style="list-style-type: none"> - Referral to outside counseling - After-school detention (long term) - Full day detention(s) - Out of school suspension(s) - Bus suspension; all buses (long term) - Central Office Review or Superintendent's Hearing - Removal from all extra-curricular activities; including trips (long term) 	<ul style="list-style-type: none"> - Referral to outside counseling - Full day detention(s) - Out of school suspension(s) - Superintendent's Hearing - Police Notification - Removal from all extra-curricular activities; including trips (school year)

*Parent notification will occur in regard to disciplinary infraction at all levels.

*Students will be provided with academic work as well as assignments that address the exhibited behaviors.

* Islip Middle School employs a progressive discipline model with consequences getting progressively stricter for students with persistent disciplinary issues.

* Students suspended (in or out of school) may be removed from extra-curricular activities for five days following their return to classes.

****PLEASE NOTE:** The building administrator or designee shall have ultimate authority for school discipline. They may interpret the discipline policy as it relates to specific students and the circumstances surrounding the specific behavioral infraction in question, thus the level of potential consequence may differ from the levels listed above. Behavioral infractions not listed above will be dealt with accordingly.

ELA Non-Negotiables

Middle School Grammar Non-Negotiables

Non-negotiable means: not open to discussion or modification. Below is a list of grammar rules/concepts that you are fully responsible for knowing and correcting on your own. Students will be held accountable to all of the items below in all writing that they complete at IMS during the school year.

- Capitalization: Students will use correct capitalization throughout their writing.
 - a. All proper nouns
 - b. The pronoun “I”
 - c. The first letter at the beginning of a sentence
 - d. In titles
- Common homophones: Students will use the appropriate word in context.
 - a. to, two, and too
 - b. your and you’re
 - c. their, there, and they’re
- End Marks: Students will use correct end punctuation.
 - a. A period at the end of a declarative sentence
 - b. An exclamation point at the end of an exclamatory sentence
 - c. A question mark at the end of an interrogative sentence
- Titles properly punctuated: novels are underlined; short stories, poems, and articles are in quotations
- Complete sentences: Students will write in complete sentences throughout their composition
- Proper format of paragraph-indenting: Students will indent each paragraph in their writing
- Words around the room/Words in text spelled correctly
- Writing margin to margin on the line
- Absolutely no “text language” or non-standard abbreviations (‘cause/cuz, lol, u, i, ur ima, 2, gonna, wanna etc...)

Teacher/Parent/Student Compact

Student's Name: _____ Grade: _____ Advisor: _____

When parents actively participate in their child's education, children do better in school. While neither parents nor schools alone can ensure the educational success of a student, the Islip School District encourages collaboration between parents and their child's school.

Our faculty agrees to encourage and support student learning by

- enforcing a cell phone free Middle School
- recognizing and believing that all children can learn
- showing respect for each child and his/her family
- coming to class prepared to teach
- providing an environment conducive to learning
- helping each child grow to his/her full potential
- providing meaningful open lines of communication with each student and his/her family
- seeking ways to involve parents in school programs
- demonstrating professional behavior and a positive behavior

As a parent/guardian, I will encourage and support my child's learning and well-being by

- supporting a cell phone free Middle School
- seeing that my child attends school regularly and on time
- providing a home environment that encourages my child to learn
- insisting that all homework assignments are completed
- communicating regularly with my child's teachers
- supporting the school in developing positive behaviors
- encouraging my child to read at home and to monitor his/her TV, phone, and computer usage
- showing respect and support for my child, his/her teachers, and the school.
- agreeing that my child will not use their cell phone during the day in the Middle School

As a student, I will encourage and support my learning by

- not using my cell phone while at IMS
- always trying to do my best in my work and in my behavior
- working cooperatively with my classmates
- showing respect for myself, my school, and other people
- obeying the school rules
- taking pride in my school
- coming to school prepared with my homework done and with my supplies
- believing that I can learn and will learn
- seek extra help when needed
- agreeing not to use my cell phone during the day at the Middle School

Parent/Guardian Signature: _____ Date: _____

Student's Signature: _____ Date: _____

Advisor's Signature: _____ Date: _____

Principal: Timothy P. Martin Date: September 1, 2023